

Better Homes and Gardens Special Interest Publications

kitchen+ bath makeovers

**Storage-
Packed
Small Bath**
p. 94

**BIG
DREAMS**
Real Budgets

Custom Look
for a DIY Price
p. 64

Style on the Cheap
\$15 Backsplash
p. 70

Summer 2011
Display until August 16
bhg.com/kitchen

**REPAIR + REPURPOSE + REFRESH =
Looks You'll Love!**





EXPERIENCE

A beautiful start
to every day.



We sell more bath products
from top brands like
Kohler, Moen and Delta
than any national home
improvement retailer.



kitchen+bath makeovers™

Summer 2011

Check out
our 13 pretty-
but-practical
kitchen
and baths!

contents

kitchens

- 36 DÉJÀ BLUE** TV designer Sarah Richardson fashions a new look for a lucky homeowner's dark and dated kitchen.
- 44 CURRENT EVENT** This designer's own Chicago kitchen is clean, uncluttered, and so sophisticated.
- 50 SCIENCE OF STYLE** A neuroscientist and a biologist give their old kitchen new chemistry.
- 58 COLOR IT COMFORTABLE** Bright pops of orange against white transform a kitchen.
- 64 PRACTICAL MAGIC** An architect achieves a high-end look on a budget.
- 70 RENEWED CHARACTER** Check out this cute bungalow kitchen in Oregon.
- 76 ELEGANT EVOLUTION** See how savvy homeowners got a custom-look kitchen on a bargain-lover's budget.
- 82 TIMELY UPDATE** If you like cottage and traditional style—and toile—this kitchen and mudroom brim with ideas you'll want to borrow.
- 88 WELCOME BACK** Hurricane Ivan prompted this makeover that preserves some of the kitchen's past.



p. 58



p. 94

An above-counter
sink and a wall-
mount faucet
bolster this
bath's style.

on the cover

See how TV designer Sarah Richardson transforms a kitchen for about \$11,000.

bathrooms

- 94 POCKET CHANGE** Two adjoining small baths, a half bath, and full bath, live large.
- 102 SIMPLE SOLITUDE** Serenity comes with a small price tag.
- 106 BEACH MODERN** A suburban guest bath gets a fun vibe with paint and creativity.



p. 94-101

p. 102-103

p. 64

p. 20

PHOTOGRAPHY: JENNY BRANDFORD

in this makeover RECYCLED-GLASS TILE... EYE-CATCHING LIGHT...

... CENTRAL DINING TABLE... LIFT-UP CABINET DOORS

color it comfortable

Space-extending moves and budget-stretching materials turn a tiny 1960s kitchen into a vibrant family hub.

WRITER AND FIELD EDITOR ANDREA CALGHEY
PHOTOGRAPHER ED GOHLICH

before



THIS PHOTO Orange countertops and accents pop against clean white cabinetry in Kristy and Martin Kropat's cheerful kitchen.





OPPOSITE A stainless-steel sink with an equally sleek faucet suits the kitchen's contemporary vibe. **LEFT** A bank of drawers provides handy storage; oversize pulls add to the room's contemporary aesthetic. **BELOW** Upper cabinets with frosted-glass doors hinge at the top, providing easy access to Kristy's dinnerware.

room and create a 16x9½-foot expanse that opens to the family room. She also raised the ceiling and ditched the existing fluorescent lighting in favor of recessed fixtures and a skylight. "Our skylight is actually a solar tube inset into a rectangular cutout in the ceiling that is covered in frosted acrylic," Kristy says. "It gave me the shape I wanted, plus great light at a fraction of the cost."

She also generated a feeling of greater spaciousness in other ways: White cabinets and appliances seem to recede into the walls, while frosted-glass upper cabinets are mounted well below the ceiling to leave visual breathing room. Closer to the floor, Kristy recessed the cabinetry toe-kick by 9 inches to suggest that the base units are floating. Repetition of square and rectangular shapes among the elements—cabinetry, appliances, tiles, and lighting—maintains visual continuity, which also enhances spaciousness.

To stretch her remodeling budget as she grew her

Just one look—that's all it took for interior designer Kristy Kropat and her husband, Martin, to see that the tiny and isolated kitchen of their 1960s San Diego home would have to be changed. Though previous owners

had tried to mask the 8x9-foot room's deficiencies by adding granite countertops, the couple knew it would take more than a quick fix to get the kitchen they wanted—a bright, open gathering space for themselves and their two toddlers, Lucas and Karsten.

"We longed for a kitchen as the true hub of our home," Kristy says, "a space that would flow smoothly from the living room in front to the family room and yard in back. The original kitchen was closed off, dark, and dreary, and its awkward floor plan obscured any sunlight from the family room sliders."

The solution was obvious to Kristy: Remove two walls to incorporate space from the former dining



kitchen, Kristy used cabinetry that has an expensive European look but is made in the United States. "Keeping appliances and the sink in the same place also left more money for splurges like the glass tile backsplash and aluminum pulls," she says. Kristy also purchased a combination microwave/ventilation hood that saves space and money, too. "Its white color blends with the cabinetry and doesn't scream for attention," she says.

Being flexible on appliance choices can yield big savings, Kristy says. "People don't realize there are lots of midrange appliances that may offer more options for less money than higher-end professional versions," she says. An example is the couple's economical slide-in range, which offers many of the same features as larger, pricier models.

Ample and accessible storage was also important to the couple, as they love to host large family gatherings. "While the old kitchen had no pantry, my two new 24-inch-wide pantries offer 10 roll-out shelves," Kristy says. Vertical dividers above the pantries are perfect for storing cookie sheets, while a corner cabinet between the sink and dishwasher has a two-tier lazy Susan. "Upper cabinets hinged at the top provide wonderful access because the door is above your head," Kristy says. "Nearly all lower cabinets are drawers for ease of use and better space utilization."



COLOR WITH CARE

Kristy Knapal's colorful kitchen has just the right mix of bright with white. Here are some tips for adding color.

BE CAREFUL.

Adding color can paralyze a homeowner. To overcome that fear, Kristy, an interior designer, says to mix confidence with caution. "Be fearless but strategic, too."

THINK STRATEGICALLY.

"Try using color in only one area and surround it with neutrals. This creates impact and depth without excess," Kristy says. "Also, consider using color on a horizontal surface where it is less intense than when used vertically."

CONSIDER WEAR AND TEAR.

The ends of the vibrant orange quartz surfacing countertops fall to the floor with a waterfall edge. This creates a smooth, seamless line, creating a playful vertical splash visible from the family room. It's also a practical design. "With two small boys, vulnerable white cabinet sides in a high-traffic area are sure to show wear," she says. "Because the quartz is more durable, it has passed the test without a scratch."

MIX TEXTURES.

When repeating a color, keep it interesting by varying features and finishes, as Kristy did with the white in her kitchen. "The cabinets are a white matte and the appliances are glossy," she says. The subtle interplay also provides the perfect foil to the potent pop of orange.

In a couple of final bold strokes, Kristy chose orange quartz-surfacing for the countertops, then replaced dated linoleum flooring with light ash. The Forest Stewardship Council-certified wood planks are 7 inches wide and 8 feet long, helping the room feel larger. And their color variations hide nicks.

The flooring isn't the only eco-friendly material—Kristy integrated green elements where possible. "The backsplash tile is from recycled glass," she says. "The cabinets look European but are domestic, eliminating energy to ship them and making them more cost-effective. We also kept as much of the footprint as possible and reused the original window. Finally, better light from the family room and from our new skylight saves on electricity."

Now, just one look at this kitchen is bound to turn anyone green—with envy. 🍋

RESOURCES BEGAN ON PAGE 110.

ABOVE To the right of the range is a stack of drawers for handy storage. The backsplash gets some zip from a mosaic tile backsplash with a subtle shimmer.

{ about this makeover }

THE FLOOR PLAN

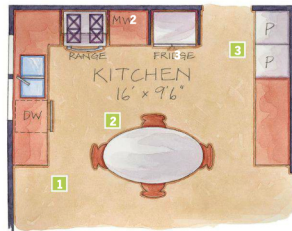

1. OPENED UP THE SPACE

Removing walls and relocating a dining area allowed the kitchen to expand and open to the adjacent family room.

2. SET THE TABLE

The dining area now straddles the space between the kitchen and family room, creating a welcoming central gathering place.

3. ADDED STORAGE

A new pantry wall boosted the kitchen's capacity to efficiently store canned goods, baking supplies, pastas, and snacks.



THE DETAILS

ABOVE An orange runner, striped napkins, and eggcups, from Martin's native Germany, complement the kitchen's Euro feel in a colorful way.

RIGHT The tones in the mosaic tile backsplash provides a band of subtle texture amid the smoothness of flat-panel cabinetry and quartz-surfacing counters.



THE BUDGET

APPLIANCES

■ Dishwasher	1,100
■ Microwave/hood	300
■ Range	1,800
■ Refrigerator	2,300

CABINETS

■ Cabinets (nonglass) and installation	11,500
■ Glass cabinet doors	4,600
■ Hardware	1,000

PLUMBING

■ Faucet	300
■ Sink	900

SURFACES

■ Backsplash tile	792
■ Countertops, including labor	5,400

MISCELLANEOUS

■ Chandelier	230
■ Recessed lighting	1,230

TOTAL

\$31,452

Resources

kitchen+bath makeovers™

WHAT IT IS AND WHERE TO FIND IT!

Most of the products shown in *Kitchen and Bath Makeovers* magazine can be obtained locally. For more information, contact the sources listed in this section. Addresses and phone numbers have been verified, but we cannot guarantee availability of items.

Budget Kitchen Makeover Pages 16-19

Backsplash tile #BCB7021 Bro Blend—[cadwallers.com](http://www.cadwallers.com)
Mat—[cadwallers.com](http://www.cadwallers.com)
Simplex single-handle pullout #K-649—[Kohler.com](http://www.kohler.com)
Window seat fabric inlet Stripe in Jet—[Outdoor Fabrics.com](http://www.outdoorfabrics.com)
Track lighting Tekla 5-Light Contemporary—[Lowe's.com](http://www.lowe.com)
Subway tile—[Home Depot USA, Inc.](http://www.homedepot.com)

Budget Chic Pages 24-26

Professionals interviewed:
Rebecca Flynn, CKBD, Borelli Design + Cabinetry, San Diego; 619/692-0734; www.borellidesign.com
Ruth Ann Taylor, CKBD, Casseidy & Fathbach, Pittsboro, North Carolina; 919/542-2578; www.casseidyandfathbach.com
Nancy Young, CKBD, Liseryn Kitchen & Bath Showroom, Montgomery, Alabama; 334/262-2799

Weekend Projects Pages 29-33

Hutch panel Refreshed Khaki #SW6149, **wall paint** Quiver Tan #SW6151—[The Sherrin-Williams Co.](http://www.sherrinwilliams.com); 800/474-3794; sherrinwilliams.com [P]
Wallpaper Night Club #GS4821—[Yorkwall.com](http://www.yorkwall.com)
Lighting; 800/375-9675; www.yorkwall.com
Place mat, **kitchen towels**—[Target Stores](http://www.target.com); 800/800-8800; www.target.com (product line varies).
Page 31
Fabric for shade—[Jo-Ann Stores](http://www.jo-anns-stores.com); 888/735-

4120; [jo-anns-stores.com](http://www.jo-anns-stores.com)
Spray paint for lamp American Accents Smooth Satin Finish Spray in Green Apple—[Rust-Oleum.com](http://www.rust-oleum.com); 800/323-3584; rustoleum.com
Tablecloth, napkins, place mat—[Target Stores](http://www.target.com); 800/800-8800; www.target.com (product line varies).
Page 32

Faucet Glacier Bay #102856, **sink** Glacier Bay drop-in bowl in white—[Home Depot USA, Inc.](http://www.homedepot.usa.com); www.homedepot.com (product line varies).
Towel ring from the Morieth collection in polished chrome, **soap dish** DwellStudio, **towel**—[Target Stores](http://www.target.com); 800/800-8800; www.target.com (product line varies).
Wall paint Heartfelt #SW6586—[The Sherrin-Williams Co.](http://www.sherrinwilliams.com); 800/474-3794; sherrinwilliams.com [P]

Tile tattoos Bembridge black-on-red—[Jane.com](http://www.jane.com); 2 June Co.; 813/832-5263; www.jane.com [P]
Wallpaper Cabin Boards in white #CT1937—[Yorkwall.com](http://www.yorkwall.com)
Wallcoverings; 800/375-9675; www.yorkwall.com

Déjà Blue Pages 36-43

Interior designer: Sarah Richardson, Sarah Richardson Design; [sarahrichardson.com](http://www.sarahrichardson.com)
Refrigerator—[Samsung.com](http://www.samsung.com); 800/726-7864; www.samsung.com
Range—[Capital Range Co.](http://www.capital-cooking.com); 866/402-4600; www.capital-cooking.com
Range hood—[Arca Electric Co., Ltd.](http://www.arca-electric.com); 800/967-3934; www.arca-electric.com
Dishwasher—[GE Appliances](http://www.appliances.com); 800/636-2000; www.appliances.com
Microwave—[Panasonic USA](http://www.panasonic.com); 800/211-7262; www.panasonic.com
Sink, faucet Simplex—[Kohler Co.](http://www.kohler.com); 800/456-4337; www.kohler.com
Backsplash tile glass and natural stone mosaic—[American Ocean Tile](http://www.american-ocean-tile.com); 888/268-8453; www.american-ocean-tile.com
Cabinet hardware—[Lee Valley Tools, Ltd.](http://www.lee-valley-tools.com); in the United States; 800/877-8158; in Canada; 800/267-8767; www.leevalley.com

Countertops Compact Quartz in Lactea—[Interstone Marble & Granite, Ltd.](http://www.interstone.com); www.interstone.ca; **Flowering**—[Marmoleum](http://www.marmoleum.com), Forbo Lindero, Inc.; 866/627-6653; www.marmoleum.com
Kitchen table, bulletin board purchased at a mirror—[IKEA, United States](http://www.ikea.com); 877/345-4532; Canada; 888/932-4532; www.ikea.com
Fabric for bulletin board Orissa, **fabric for chair cushions** Gabriel—[Thibaut Design](http://www.thibaut-design.com); 800/223-0704; www.thibaut-design.com
Fabrication of bulletin board—[Elgin Picture & Frame, Inc.](http://www.elgin-picture.com); Toronto; 416/532-7031; www.elginpictureandframe.com
Counter stools—[Machine Age Modern](http://www.machinemade.com); Toronto; 416/461-3088; www.machinemade.com

Pendant lights at island—[Union Lighting](http://www.union-lighting.com); Toronto; 416/652-2200; www.unionlightingandinteriors.com
Pendant light at table—[Absolutely, Inc.](http://www.absolutely.com); Toronto; 416/521-1756; www.absolutely.com
Vintage plates and glasses—[Elegant Garage Store](http://www.elegantgarage.com); Toronto; 416/322-9744; www.elegantgarage.com
Mixing bowls, vases, flowerpots, cookbooks, pencil holder—[HomeSense](http://www.home-sense.com); 866/466-3707; www.home-sense.ca
Shell bowls—[Bronze](http://www.bronze.com); Toronto; 416/913-6545

Current Event Pages 44-49

Interior and kitchen designer: Hilary Bales, Hilary Bales Design, Ltd.; Chicago; 773/489-7100; www.hilarybalesdesign.com
Cabinetry—[Abria Kitchen Design](http://www.abria-kitchen-design.com), Chicago; 312/943-7667; www.abriadesign.com
Cabinet hardware—[Clark & Barlow Decorative Hardware](http://www.clark-barlow.com); 800/439-3225; www.clarkbarlow.com
Tile for backsplash—[Tile Outlet](http://www.tile-outlet.com), Chicago; 773/276-2662; www.tileoutlet.com
Countertop Stellar Snow—[Silestone by Cosentino USA](http://www.silestone.com)

800/291-1311; www.silestoneusa.com
Refrigerator, range, dishwasher, and microwave Profile—[GE Appliances](http://www.appliances.com); 800/626-2000; www.appliances.com
Sink—[Blanco America, Inc.](http://www.bianco-america.com); 800/451-5782; www.biancoamerica.com
Faucet—[HWC Faucets, Inc.](http://www.hwc-faucets.com); 888/592-3287; www.hwc-faucets.com
Bar stools Cerutti Balen Cafe Modern barstool by Philippe Starck—[available through Starck](http://www.avacible.com); 866/939-9545; www.starck.com
Bowl holding organizers—[Chiasso](http://www.chiasso.com); 800/654-3570; www.chiasso.com
Container holding utensils—[Crate & Barrel](http://www.crate-barrel.com); 800/947-6666; www.crateandbarrel.com (product line varies).
Vase on dining table—[Room & Board](http://www.room&board.com); 800/486-6554; www.roomandboard.com
Red pot—[Le Creuset of America](http://www.le-creuset.com); 877/273-8738; www.lecreuset.com

Science of Style Pages 50-57

Cabinetry Hayward with full-extension glide drawer upgrade in canvas painted finish—[KraftMaid Cabinetry](http://www.kraftmaid.com); 800/571-0900; www.kraftmaid.com
Cup pulls for drawers Illinois, **door pulls** Aubrey—[Restoration Hardware](http://www.restorationhardware.com); 800/930-9836; www.restorationhardware.com
Kitchen countertop Marone Emperor—[DuPont Zodiac Quartz Surfaces](http://www.duPontZodiac.com); 877/229-3935; www.duPont.com
Counter at peninsula Numerical solid oak countertop—[IKEA, United States](http://www.ikea.com); 877/345-4532; Canada; 888/932-4532; www.ikea.com
Range #VGC3084BSS from the Stainless Steel Professional series, **vent hood** wall-mount canopy range hood #VWH3003SS from the Professional series 460 CFM—[www.vikingrange.com](http://www Viking Range Corp.; 888/845-4641; <a href=)
Refrigerator countertop-depth side-by-side refrigerator #BCC2080SBN from the Evolvers 800 series, **dishwasher** Intra #950 5+056, **microwave** built-in convection microwave #MB8090 from the Stainless Steel 800 series—[Bosch](http://www.Bosch.com); 800/866-2022; www.boschappliances.com
Knob set for interior entry door Providence in oil-lubbed bronze—[Ernest Products, Inc.](http://www.ernest-products.com); 800/356-2741; www.ernestproducts.com
Sink single-bowl undermount with shell grid #PRK10-21—[Franke Kitchen Systems Division](http://www.franke-kitchen.com); 800/626-5771; www.franke.com
Faucet Interaktif Solaris faucet with pullout—[Hansgrohe](http://www.hansgrohe.com); 800/334-0455; www.hansgrohe-usa.com
Pendant over peninsula framed acrylic hanging lamp—[Gus Design Group](http://www.gus-design.com); 416/534-0773; www.gusdesign.com
Chandelier over table Deco Deluxe pendant lamp in Kinoro fabric, **wall sconce in butler's pantry** Mendris small wall sconce in Kinoro fabric—[Lights Up!](http://www.lights-upt.com)

Brooklyn; 718/513-3770; lights-upt.com
Recessed lighting 5-inch recessed lights with white baffles—[Lightolier](http://www.lightolier.com); a Philips Group brand; 800/215-1068; www.lightolier.com

Color It Comfortable Pages 58-63

Interior designer: Kristy Kropat, allied member ASID, Kropat Interiors, San Diego; 858/405-3535; www.kropatinteriors.com
General contractor: Paul Hesikola, Hesikola Construction, Chula Vista, California; 619/200-1992

Cabinetry Venesia—[KraftMaid Cabinetry](http://www.kraftmaid.com); 888/562-7744; www.kraftmaid.com
Countertops—[CaseStone USA](http://www.casestoneusa.com); 877/987-2789; www.casestoneusa.com
Cabinet pulls—[Hifele America Co.](http://www.hife.com); 800/423-3531; www.hife.com
Backsplash—[Oceanis Glass&Tile](http://www.oceanis-glass.com); 877/648-8222; www.oceanis-glass.com
Refrigerator, dishwasher—[Jenn-Air](http://www.jenn-air.com); 800/443-3531; www.jenn-air.com
Range, microwave Kenmore Elite—[Sears Kenmore](http://www.sears-kenmore.com); 888/536-6673; www.kenmore.com
Sink—[Blanco America, Inc.](http://www.bianco-america.com); 800/451-5782; www.biancoamerica.com

Faucet—[Grohe America](http://www.grohe-america.com); 800/201-3407; www.groheamerica.com
Flooring—[Kahrs International, Inc.](http://www.kahrs-international.com); www.kahrs.com
Chandelier—[Kartell](http://www.kartell.com); 866/854-8823; www.kartell.com
Window coverings—[Kathy Clements, Interior Window Designs](http://www.kathy-clermont.com), La Brea, California; 619/890-2713; e-mail: window_design@kathy.com
Dining chairs—[Scantum Furniture](http://www.scantum-furniture.com), San Diego; 858/537-9050; www.scantumfurniture.com
Dining table—[Plummins](http://www.plummins.com), San Diego; 858/566-7560; www.plummins.com
Tea towels, wooden tray with covers—[Crate & Barrel](http://www.crate-barrel.com); 800/967-6666; www.crateandbarrel.com (product line varies).
Yellow pot—[Marshall Wallace](http://www.marshall-wallace.com); 800/627-7425; www.marshall-wallace.com (product line varies).
White vases—[IKEA](http://www.ikea.com)

United States; 877/345-4532; Canada; 888/932-4532; www.ikea.com
Flatware—[Villeroy & Boch Tableware](http://www.villeroy&boch.com); 800/845-5376; www.villeroy-boch.com
White tray by sink—[CBR](http://www.cbr.com); 800/606-6252; www.cbr.com
Wineglasses—[Riedel Retail Corp.](http://www.riedel.com); 888/474-3335; www.riedel.com
Orange table runner—[Warwick](http://www.warwick.com); 888/454-0347; www.warwick.com
Tall white vase with hole, metal wire fruit bowl—[Hold It Contemporary Home](http://www.hold-it.com), San Diego; 619/295-6660; www.hold-it.com
Square white plates, white tray, white serving bowl with lid—[Thomas Rasch Ltd.](http://www.thomas-rasch.com); www.thomas-rasch.com
Striped napkins—[WorldMarket](http://www.worldmarket.com); 800/626-8758; www.worldmarket.com

Practical Magic Pages 64-69

Architect: Rob Whitehead, AIA, LEED AP, Whitehead Design Workshop, Des Moines; 515/419-8366; www.whiteheaddesignworkshop.com
Wineglasses, **flanking island**, **pantry** custom cabinets with black laminate doors—[Tony Lisc Construction](http://www.tony-lisc.com), West Des Moines, Iowa; 515/225-8830
All other cabinetry, in-cabinet lighting, lighting above sink, cabinet hardware, faucet—[IKEA, United States](http://www.ikea.com); 877/345-4532; Canada; 888/932-4532; www.ikea.com
Backsplash and countertop Tropical Brown granite—[Renaissance Marble & Granite](http://www.renaissance-marble.com), Urbandale, Iowa; 515/276-4260; www.renaissance-marble.com
Sink—[Faucet Direct](http://www.faucet-direct.com); 800/964-2555; www.faucet-direct.com
Hood—[Ood Kitchen, Inc.](http://www.ood-kitchen.com); Hayward, California; 510/266-0099; www.ood-kitchen.com
Wall paint Grizzle Gray #SW7068—[The Sherrin-Williams Co.](http://www.sherrinwilliams.com); 800/474-3794; sherrinwilliams.com [P]
Stainless-steel panels for refrigerator—[Hawk Metal](http://www.hawk-metal.com), West Des Moines, Iowa; 515/225-3008
Microwave—[GE Appliances](http://www.ge.com); 800/626-2000

Key

[T] TO THE TRADE ONLY These items or services are not available to the general public. Contact a design professional for help.

[P] PAINT COLOR Because of the magazine printing process, paint colors depicted on our pages may vary slightly from manufacturers' colors. Use paint color names or numbers, when provided, as a starting point. To get the exact color you see in the magazine, take the page to a paint retailer for matching.